

M25 Asymmetrical Handrail Light



- LED handrail lighting system, suit for standard handrail made by stainless steel and aluminum.
- Different colors from 2700- 6000K , Amber, Green and blue for LEDs are available, IP67 waterproof.
- Suit for Standard $\varnothing 48-63\text{mm}$ handrail wall thickness 1.0-1.5mm for a $\varnothing 27$ hole.
- 3M waterproof internal connectors.
- Can be driven by 12V and 24V LED power supply.
- Stainless steel housing.
- Customized sizes, shape and beam angle on request.
- 12-24VDC LED Handrail Light is not dimmable.

Please only use constant voltage driver for 12-24VDC LED Handrail Light, constant voltage + constant current driver is not workable.

Suit for class 2 power unit, maximum connected power not more than 100W.

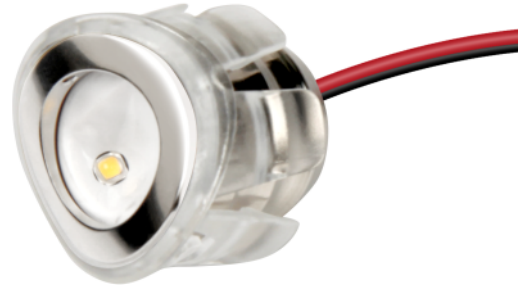

CE RoHS



Beam angle



IP Rating



DC-IN



Easy Installation



Extreme Environments

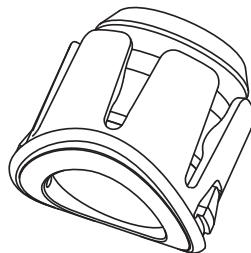
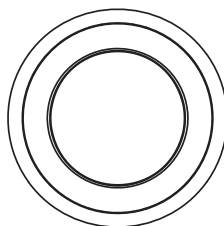
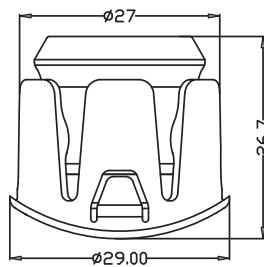
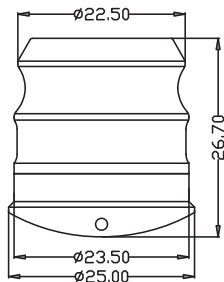
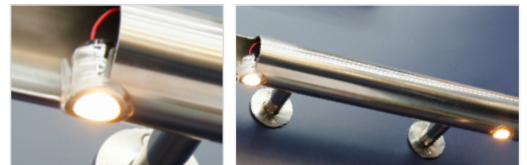

Basic Parameter

M25 Asymmetrical Handrail Light

LED Brand	Philips/Cree
LED Q'ty	1 PC
Lamp housing material	Stainless Steel
Cover (Diffuser) material	PMMA
Working Temperature	-20~+45 °C
IP Class	IP67
Beam Angle	80 °

Electrical Parameter

Power	1.5W
Input Voltage	24 V

Optical Parameter

CCT	2700K 3000K 4000K 6000k
Luminous Flux	109Lm
Luminous Efficiency	73.3 Lm/W
CRI	≥80

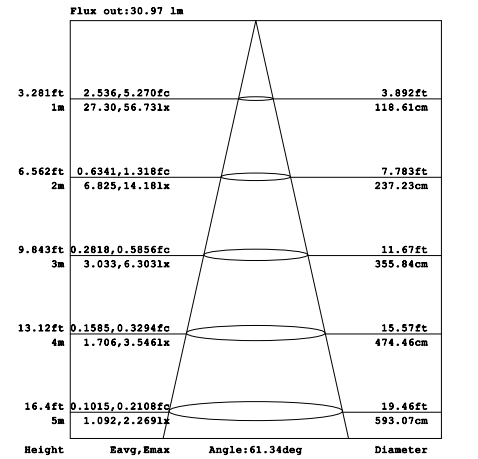

Effective Average Illuminance

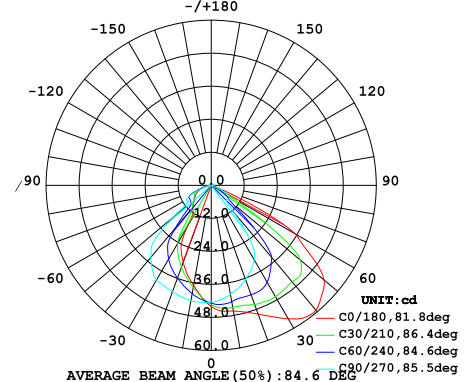

Light Distribution Curve

Installation Method

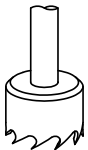

HOLE SAW

Hole saw suitable for handrail thickness < 3mm, 200-450RPM, can be used not more than 20 times

